

stay•safe® Drain Set

Capacity: 3L

Cat. No. 026-20030

Sterile single-use disposable

Storage: Store at room temperature. Protect from excessive heat and freezing.

INSTRUCTIONS FOR USE (IFU)

CAUTION: Federal law restricts this device to sale by or on the order of a physician.

Touching the inside of the PIN connector may increase the risk of infection.

INDICATIONS FOR USE

The stay•safe Drain Set is indicated for use by patients with acute and chronic end-stage renal disease undergoing peritoneal dialysis (PD) in a healthcare facility or at home. The stay•safe Drain Set is used to connect directly to the stay•safe catheter extension set to enable drainage and/or effluent sampling as needed. This device is compatible with Fresenius Medical Care (FMCNA) Peritoneal Dialysis (PD) stay•safe catheter extension sets.

PRECAUTIONS

Ensure connections are secure prior to use.

STERILE PRODUCT: EO STERILIZED

Cap must be in place to ensure sterility and a non-pyrogenic fluid pathway.

SAMPLING PROCESS

Ensure facility procedure is followed when performing effluent sampling from the drain set.

WARNINGS

Use aseptic technique with every connection and disconnection to reduce the risk of infection.

For single-use only. Do not reuse, reprocess, or resterilize this product. The reuse of the line may increase the risk of peritonitis.

Drain set is packaged with cap in place. Cap must be in place prior to use. The use of an uncapped or damaged product may increase the risk of infection.

Patents apply, visit www.fmcna.com/patents

This product and package are not made with natural rubber latex.

Assembled in Mexico.

SAVE THESE INSTRUCTIONS

COMPONENTS REFERENCED IN IFU STEPS

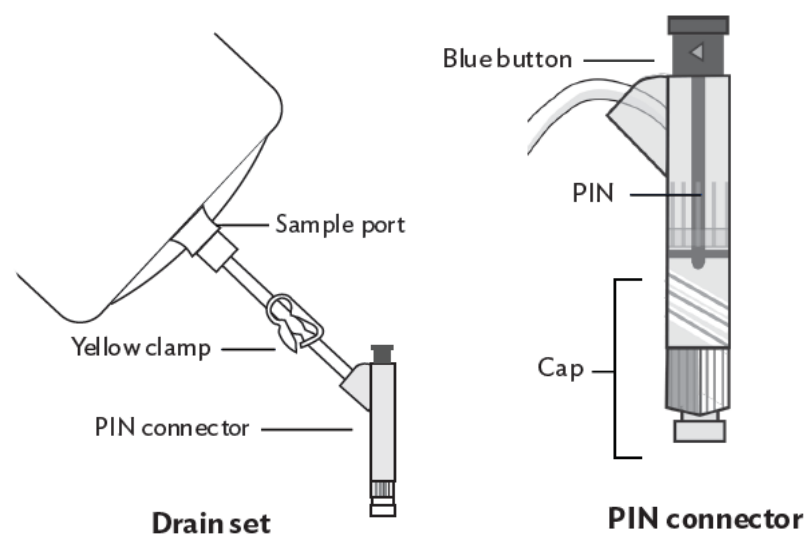

CONNECTING

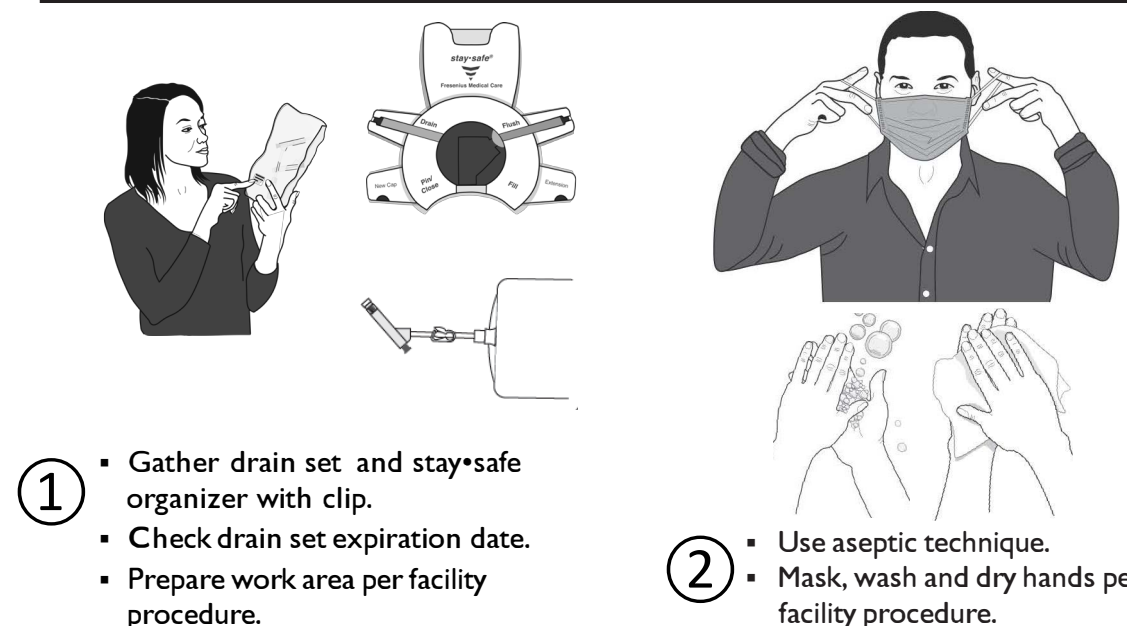

- Gather drain set and stay•safe organizer with clip.
 - Check drain set expiration date.
 - Prepare work area per facility procedure.

- Use aseptic technique.
 - Mask, wash and dry hands per facility procedure.

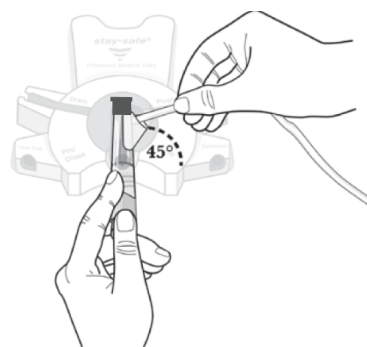

- Insert the PIN connector at a 45 degree angle into the opening of the organizer clip.
 - Press down on the PIN connector to ensure a snug fit in the organizer clip.

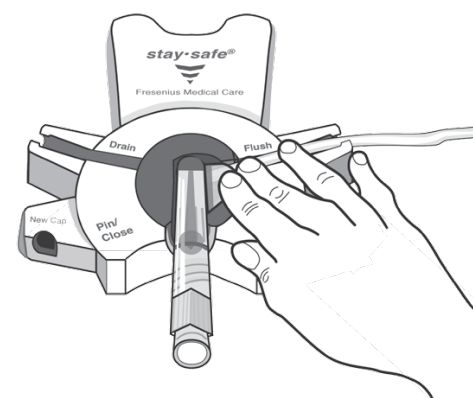

- Press the drain set line into the right tubing channel of the organizer.

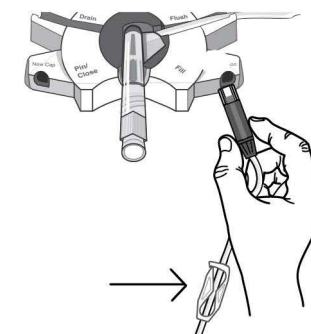

- Make your PD catheter extension set accessible. Be sure the catheter extension set white clamp is closed.
 - Place the end of the catheter extension set into the right notch of the organizer.

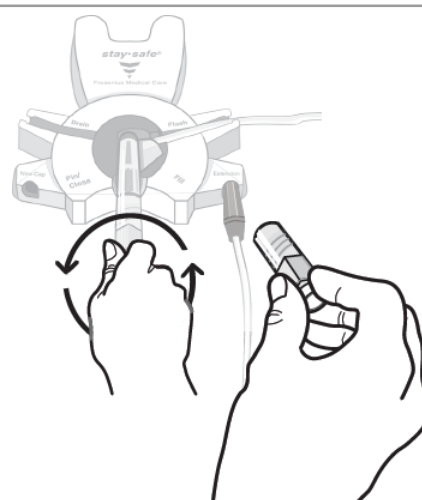

- Sanitize your hands.
 - Holding the flat gripping surface, unscrew the cap from the PIN connector and set aside.

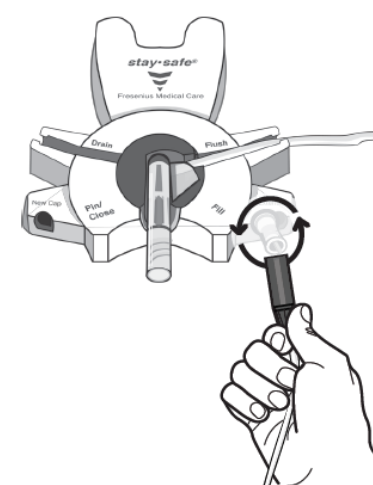

- Unscrew the catheter extension set from the stay•safe cap.

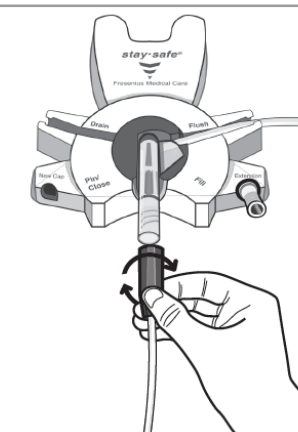

- Connect the catheter extension set to the PIN connector.
 - Open catheter extension set white clamp and begin to drain.
 - Remove your PIN connector from the organizer.

DISCONNECTING



- ① ▪ Use aseptic technique per facility procedure.

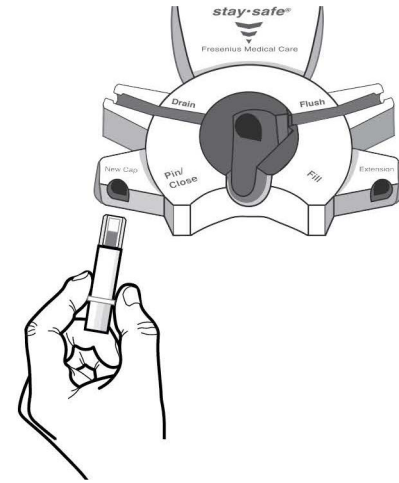

- ② ▪ Place a new stay•safe cap into the left notch of the organizer.

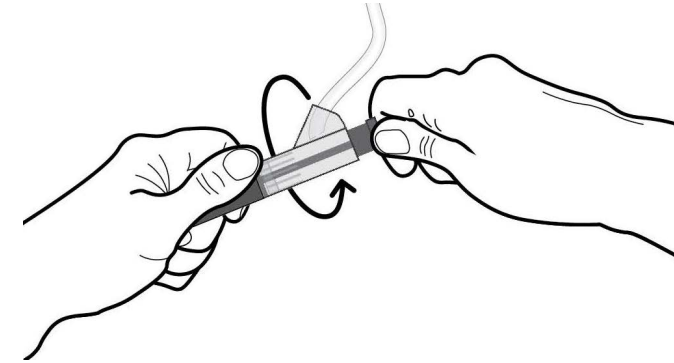

- ③ ▪ Ensure catheter extension set white clamp is open. Turn the blue button on the PIN connector 1/4 turn clockwise to unlock.

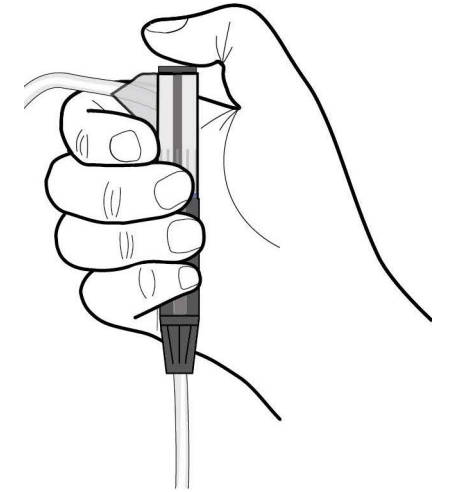

- ④ ▪ Press the blue button to insert the PIN into the catheter extension set.

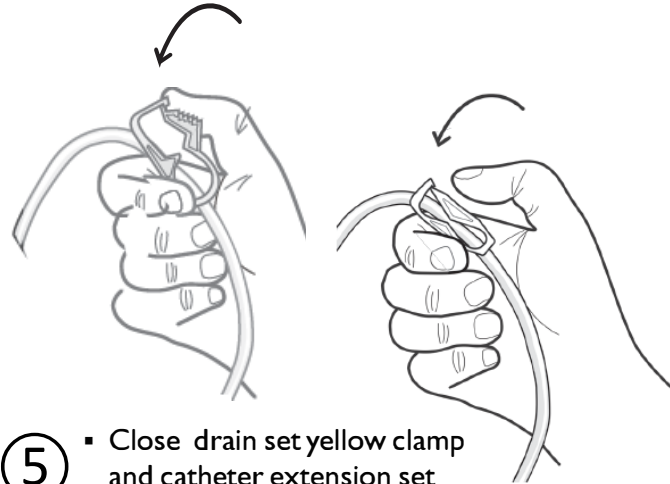

- ⑤ ▪ Close drain set yellow clamp and catheter extension set white clamp.

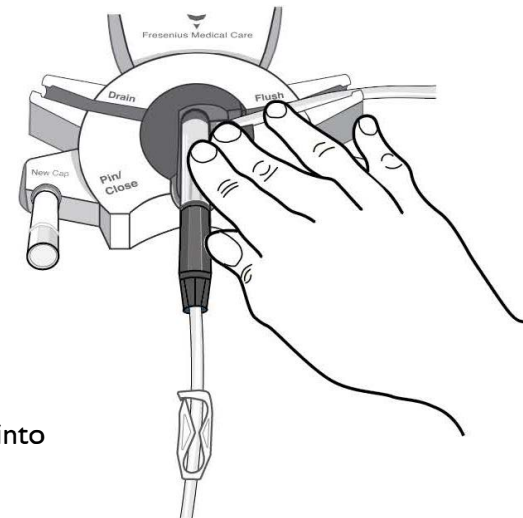

- ⑥ ▪ Insert PIN connector into organizer clip.

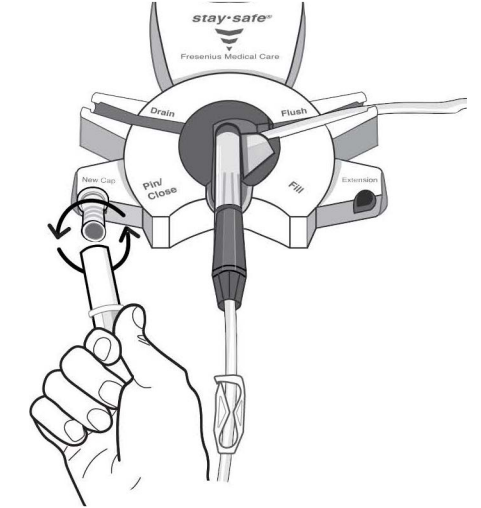

- ⑦ ▪ Unscrew and remove protective cover from new stay•safe cap.
▪ Set aside for later use.

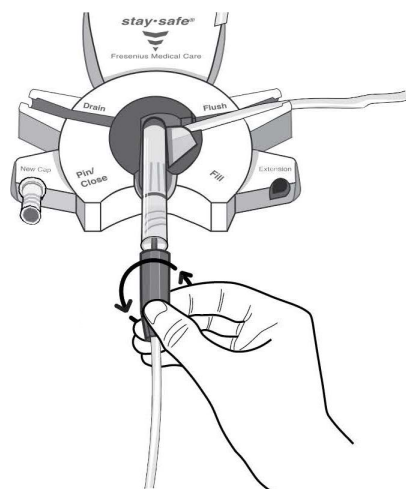

- ⑧ ▪ Unscrew the catheter extension set from the PIN connector.

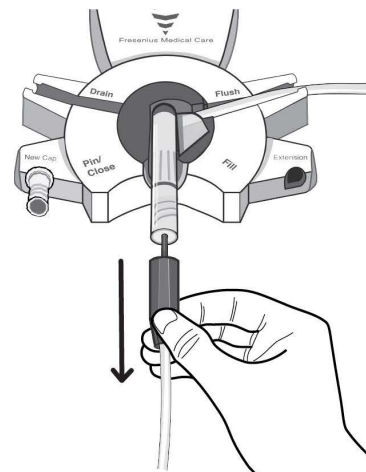

- ⑨ ▪ Pull the catheter extension set back from the PIN connector without bending or twisting the PIN.
▪ Hold the catheter extension set up slightly.
▪ Be sure the PIN is visible.

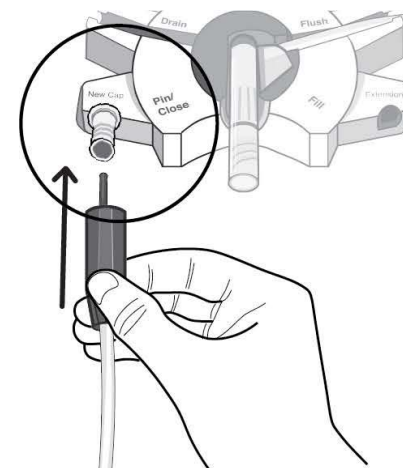

- ⑩ ▪ Immediately connect the catheter extension set to the new stay•safe cap.
▪ Remove the catheter extension set from organizer notch. Make sure cap is tight.



- ⑪ ▪ Place the protective cover from the stay•safe cap on the PIN connector and discard.
▪ Follow your PD Nurse's instructions for disposal of drain set per local regulations.